

BioHorizons CAD-CAM Bars 3Shape Library Rev C Release Notes

What's New

- Added Open Implant 3915 scan body for abutment level

Supported Components



Connections

- Implant Level: BioH 3.0mm, 3.5mm, 4.5mm, 5.7mm
- Abutment Level: BioHorizons Multi-Unit

- Implant level:



Elos IO (IO-11A-x)



3Shape (BI3, BIY, BIG, BIB)

Scan Bodies

- Abutment level:



Elos IO (IO-11B-A)



Open Implants (3915)



Imetric MU

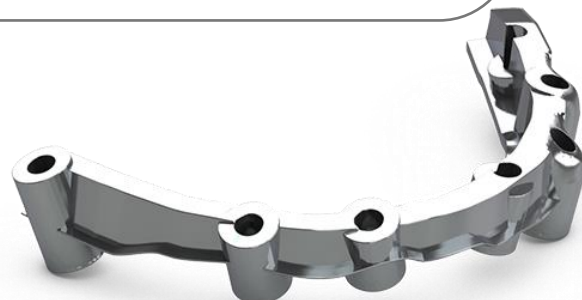
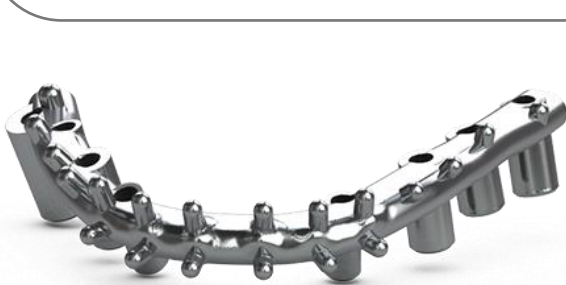

Revision History

Rev B

- updated MU inner limit file to prevent thickness error
- updated Imetric scan body geometry
- added IO-11A-A as a 3.0mm implant level scan body

Rev A - initial release